

Elysian Tower-B

- Upto 69 floors including Podium
- RERA possession: June-2027
- 6 apartments on each floor

***All apartments along with a spacious Balcony in the living Room**

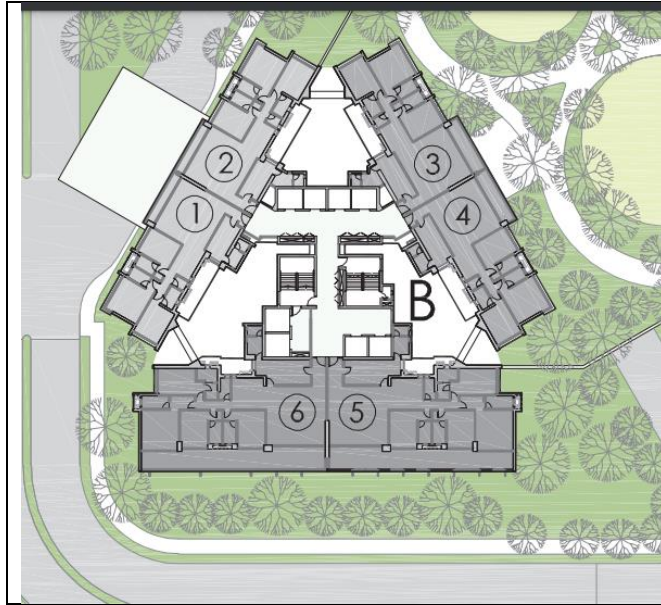

3BHK Majestic -Series-1	1795sq ft-1802 sq ft
3BHK Majestic -Series-2	1795sq ft-1802 sq ft
3BHK Palatial-Series-3	1899 sq ft-1905 sq ft
3BHK Palatial-Series-4	1893 sq ft- 1899 sq ft
4BHK Elite- Series-5	3032 sq ft- 3047 sq ft
4BHK Elite- Series-6	3027 sq ft- 3042 sq ft

CARPARKS	3BHK: -  	4BHK: -   
-----------------	---	---

PRICING:

CONSTRUCTION LINKED PLAN (47-48% Due)		BANK SUBVENTION: *With Axis & ICICI) or DEVELOPER SUBVENTION	
3BHK	4BHK	3BHK	4BHK
Rs. 24,750/ sq ft +250 Floor rise each floor per sq ft	Rs. 25,250/ sq ft +250 Floor rise each floor per sq ft	Rs. 27,750/ sq ft +250 Floor rise each floor per sq ft	Rs. 28,250/ sq ft +250 Floor rise each floor per sq ft

CLP	%
At the time of Booking i.e., on Executing the Acceptance Form (being 50% of the Earnest Money)	10
Within 30 days from Booking date upon Execution and Registration of Agreement (Including Balance 50% of Earnest Money)	15
Within 90 days from Booking date	10
Within 120 days from Booking date along with further slab in case raised	10
As per construction	Balance
Bank Subvention Scheme	%
At the time of Booking i.e., on Executing the Acceptance Form (being 50% of the Earnest Money)	10
To be paid within 30 days from the date of booking (including balance 50% of Earnest Money) and subject to Execution and Registration of the Agreement	15
To be paid within 30 days from the date of booking	5
Loan from Axis Bank or ICICI Bank	70
Developer Subvention	%
At the time of Booking i.e., on Executing the Acceptance Form (being 50% of the Earnest Money)	10
To be paid within 30 days from the date of booking, upon Execution and Registration of Agreement (Including Balance 50% of Earnest Money)	15
To be paid within 30 days from the date of booking.	5
To be paid within 60 days from the date of booking	10
At the time of handing over of the possession of the said Premises to the Allottee/s on/after receipt of the Occupation Certificate for the said Premises and after completion/installation of the door to the said Premises and installation of sanitary fittings in the said Premises	60

Special Offer:

***0 % Stamp Duty**